

# DESi

Wireless  
Touch Keypad

USER MANUAL

**WPK**

## 1. PARTS and INSTALLATION

You can install the device by using two screw holes shown on the below. If the device will be used in a secure place like an office in a secured building, it can be placed easily by using 2-way stickers provided with the product.

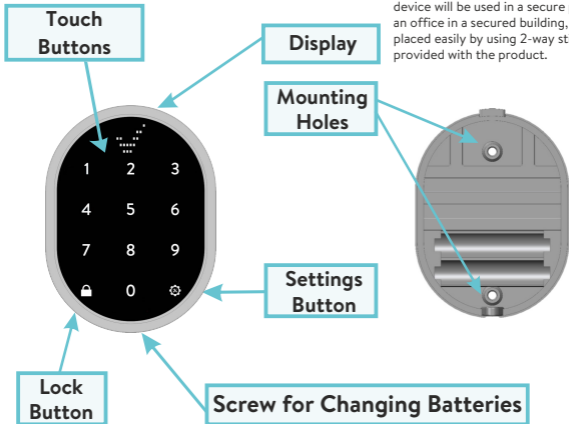

## **2. GENERAL INFORMATION and WARNINGS**

- If there is any problem with door or locking mechanism, first of all, those problems need to be solved. Otherwise, there would be problems during operating the device.
- If there is a problem with the device, contact with your dealer.
- Replace the batteries, if there is a battery warning.
- It needs to be protected from water and direct sunlight.
- Do not touch to electronic parts of the device with a conducting metal or sharp object.
- Do not use water or corrosive chemicals to clean the device.

### **2.1. KEYPAD MENU NAMES**

- 1- Pasword
- 2- Delete Password
- 3- OTP
- 4- Language
- 5- Reset

### 3. ADMINISTRATION ACTIONS / SETTINGS FOR KEYPAD

Five different 5 digit passwords may be defined to the keypad; 1 master, 4 users. All of the passwords unlock and lock. For adjusting settings, the master password need to use. Default master password is "12345". User passwords are not set.

**WARNING:** First of all, change the default master password.

#### 3.1. Changing Default Master Password

- Tap with your palm to wake up the device. Then touch the **"SETTINGS"** button. "MASTER" will be displayed on the screen.
- Enter "12345" as the default password. Sliding "<- ->" symbol will appear on the screen.
- Touch "1". "PASSWORD" will appear on the screen. Touch the **"SETTINGS"** button to enter menu.
- When the "MASTER" appears (you can touch "1") , touch the **"SETTINGS"** button again.
- Enter your new 5-digit master password when "NEW PASS" is displayed on the screen. When "REPEAT" is displayed, re-enter the 5 digit password. Thus, your master password will be changed.

### 3.2. Set / Change User Password

- Tap with your palm to wake up the device. Then touch the **"SETTINGS"** button. "MASTER" will be displayed on the screen.
- Enter 5 digit master password. Sliding "< - ->" symbol will appear on the screen.
- Touch **"1"** and "PASSWORD" will appear on the screen, touch **"SETTINGS"** . (*"MASTER" will appear if no setting has been made before*)
- Touch **"2"** and "USER" will be displayed on the screen. Then touch **"SETTINGS"** to enter user password menu.
- Enter your new 5-digit user password when "NEW PASS" is displayed on the screen. When "REPEAT" is displayed, re-enter the 5 digit password. Thus, your user password will be set.

*You can add other user password by following the same steps.*

### 3.3. Delete Passwords

- Tap with your palm to wake up the device. Then touch the **“SETTINGS”** button. **“MASTER”** will be displayed on the screen.
- Enter 5 digit master password. Sliding **“< - - >”** symbol will appear on the screen.
- Touch **“2”** and **“DEL.PASS”** will appear on the screen, touch **“SETTINGS”** .
- Enter 5-digit user password you want to delete when **“WRITE”** is displayed on the screen.
- When the confirmation symbol appears, the user password is deleted from keypad.

*You can also delete other user passwords by following these steps.*

### 3.4. OTP - One Time Password Feature Activation

- Tap with your palm to wake up the device. Then touch the **"SETTINGS"** button. "MASTER" will be displayed on the screen.
- Enter 5 digit master password. "<- ->" symbol will appear on the screen.
- Touch **"3"** button. "OTP" will appear on the screen. Touch **"SETTINGS"** to enter menu.
- Touch **"1"** to enable or disable OTP function and touch the **"SETTINGS"** to save your choice.

**IMPORTANT NOTE:** In order to use the OTP feature, the master controller must be a smartphone. For the usage of OTP feature and all details, please refer to OTP - Time Limited Access User Manual.

**IMPORTANT NOTE-2:** When OTP is activated, you need to touch "SETTINGS" twice to get inside settings menu.

**IMPORTANT NOTE-3:** To use the 5-digit password when OTP is activated, press the "SETTINGS" button once and enter your password.

### 3.5. Language

- Tap with your palm to wake up the device. Then touch the **“SETTINGS”** button. "MASTER" will be displayed on the screen.
- Enter 5 digit master password. Sliding “< - ->” symbol will appear on the screen.
- Touch "4" and "LANGUAGE" will appear on the screen, touch **“SETTINGS”** to enter menu.
- Scroll between language choices with pressing 1-2-3-4-5 numbers. Touch the **“SETTINGS”** to save your choice.

*English, Turkish, Russian, Italian and German languages are available.*



### 3.6. Reset

- Tap with your palm to wake up the device. Then touch the **"SETTINGS"** button. "MASTER" will be displayed on the screen.
- Enter 5 digit master password. Sliding "< - >" symbol will appear on the screen.
- Touch **"5"** and "RESET" will appear on the screen, touch "SETTINGS" to enter menu.
- "00" will appear on the screen, touch button **"1"** till you see "05" on the screen. Then touch "SETTINGS" to complete reset.

*All user passwords will be deleted and the master password will be 12345.*

## 4. USAGE

### 4.1. How To Pair Keypad and Smart Lock

If your smart lock does not receive commands from the keypad, that shows pairing is not successful.

Please follow the steps to pair the smart lock and keypad;

- 1- Connect smart lock with mobile phone, touch to settings from top right and enter USERS tab from down .
- 2- Press 'Enroll New Controller / User' and press green plus. Smart lock will give long and then short beeps.
- 3- After the short beep, tap with your palm to wake up the keypad and press '**LOCK**' button.
- 4- If the pairing is successful, sequential warning sounds will be heard from the smart lock.

## 4.2. Unlocking and Opening the Door

To wake the device, touch it with your palm and enter your 5-digit authorized password. After the animation on the screen, your lock and door will open.

## 4.3. Locking the Door

Close the door and touch it with your palm to wake up the device. By pressing the lock button, you can lock your door.

## 5. MAINTENANCE

You can clean the surfaces with soft fabric.

### 5.1 Replacing Batteries

Untighten the bottom screw and remove the keypad from base. Change the batteries, place the keypad and tighten the screw.

Use 1,5 V AA size high quality alkaline or lithium batteries only.

Desi Alarm&Security Systems

Orta Mh. Topkapı Maltepe Cd. Anadolu  
Sk. No:1 Bayrampaşa İstanbul / Turkey

[www.utopic.com.tr](http://www.utopic.com.tr)  
[www.desi.com.tr](http://www.desi.com.tr)